

104 SOUTH ROBERTSON BLVD

LOS ANGELES, CALIFORNIA

RETAIL SPACE FOR LEASE



KAZUKO Y. MORGAN
Vice Chairman
Lic. # 01070005
T 415.773.3546
kazuko.morgan@cushwake.com

CARINE MAMANN
Director
Lic. # 01734150
T 310.595.2235
carine.mamann@cushwake.com

JAY LUCHS
Executive Vice President
Lic. # 01260345
T 310.407.6585
jay.luchs@ngkf.com

EXCLUSIVE AGENT
 **CUSHMAN & WAKEFIELD**
RETAIL SERVICES
Lic. #00616335

 **Newmark Grubb
Knight Frank**

Floor Plan/ Premises

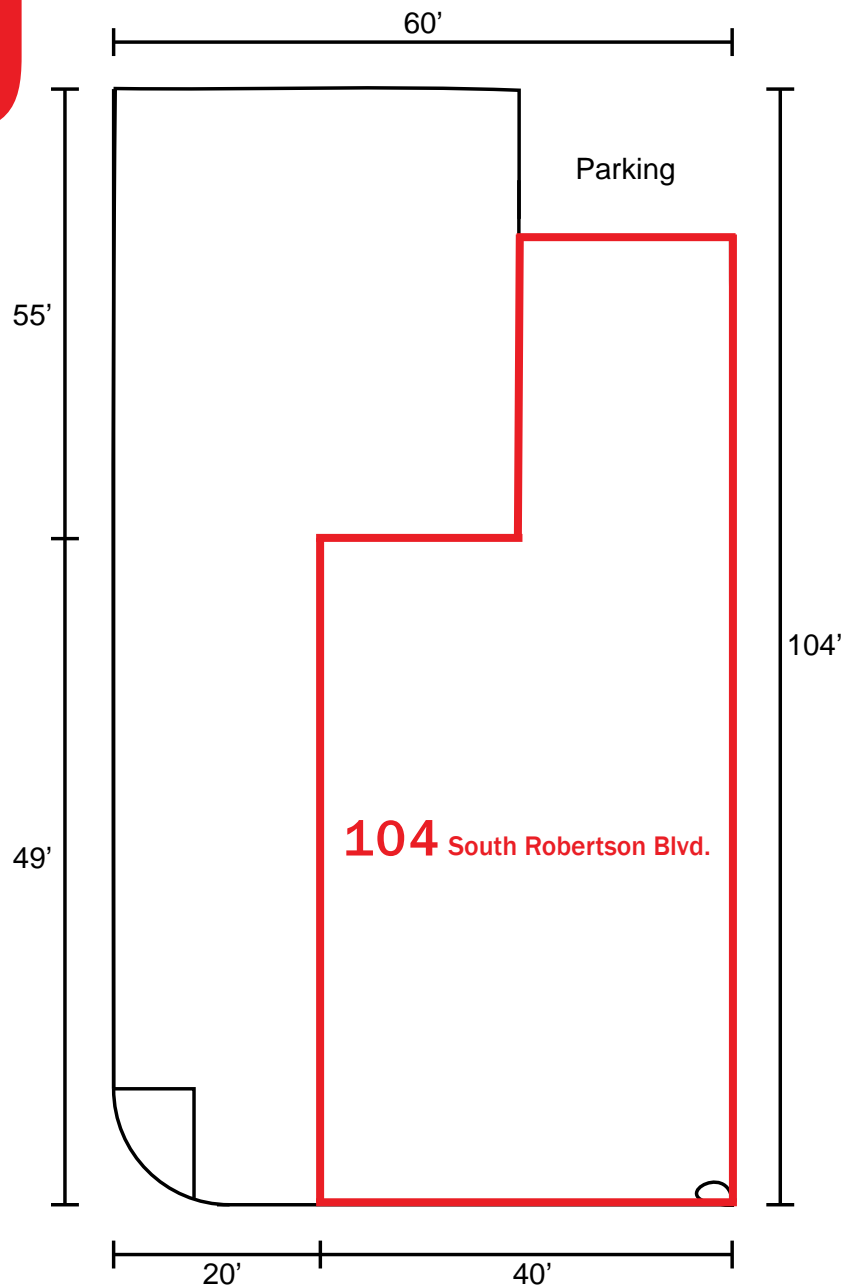

GROUND FLOOR

- $\pm 2,650$ R.S.F
- 40 Feet of 50-Yard Line Frontage
- High impact brand exposure on trend-setting street
- High ceilings and skylights



Location Map

- World renowned Robertson nearby tenants include: Tory Burch, Chanel, AllSaints Spitalfields, Alice & Olivia, Zimmermann, Monika Chiang, The Ivy, Intermix, Ralph Lauren, Lululemon, Kitson, Splendid, Joseph, and The Kooples



"No warranty or representation, express or implied, is made as to the accuracy of the information contained herein, and same is submitted subject to errors, omissions, change of price, rental or other conditions, withdrawal without notice, and to any special listing conditions imposed by the principals."

Neighboring Tenants

