

1308 ABBOT KINNEY BLVD

VENICE, CA



PREMIERE 50 YARD LINE LOCATION

EXCELLENT RETAIL OPPORTUNITY ON ABBOT KINNEY

SIZE

1,655 SF

RENT

\$16 PSF PER MONTH NNN

HIGHLIGHTS

- TWO (2) THREE (3) TON HVAC UNITS
- 200 AMPS OF ELECTRICAL SERVICE
 - THREE (3) SKYLIGHTS
- ONE (1) ADA COMPLIANT BATHROOM
 - TRACK LIGHTING
 - NEW ROOF
 - NEW STORE FRONT
 - ROLL UP SECURITY GATE
- REAR LOADING AND STORAGE AREA



JAY LUCHS

EXECUTIVE VICE PRESIDENT

Lic #01260345

T: 310.407.6585

Jay.Luchs@ngkf.com



STEVEN GELBER

Lic #00872302

T: 310.824.4999 x15

Steven.Gelber@gmail.com

WWW.JAYLUCHS.COM

WWW.ABBOTKINNEYRETAIL.COM

1308 ABBOT KINNEY BLVD

VENICE, CA

ABBOT KINNEY BLVD.

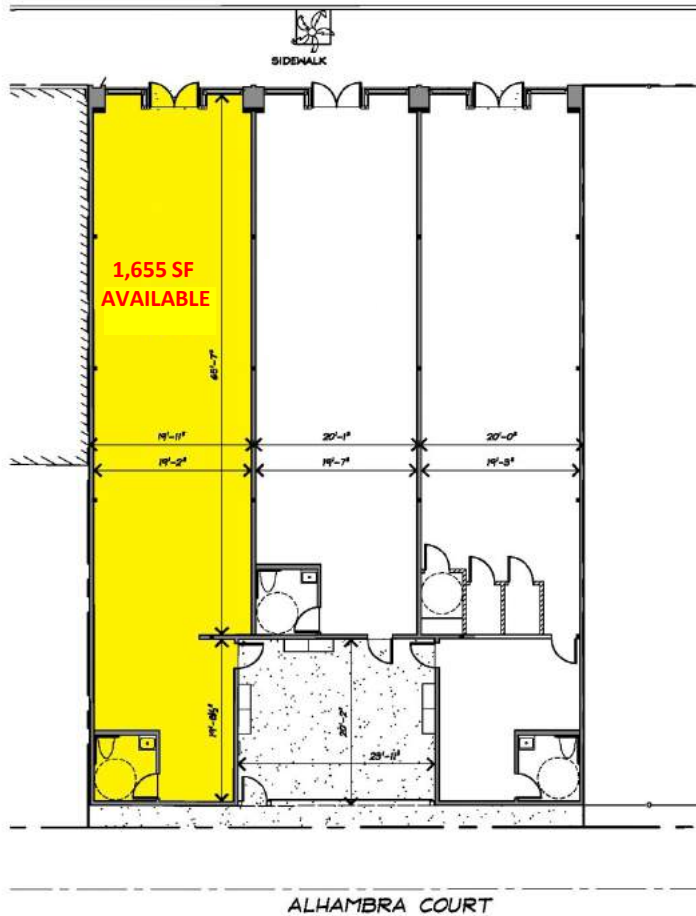

JAY LUCHS
EXECUTIVE VICE PRESIDENT
Lic #01260345
T: 310.407.6585
Jay.Luchs@ngkf.com



STEVEN GELBER
Lic #00872302
T: 310.824.4999 x15
Steven.Gelber@gmail.com

WWW.JAYLUCHS.COM
WWW.ABBOTKINNEYRETAIL.COM

WESTMINSTER AVENUE

1100	Heist
1108	C.A.V.E Gallery
1108C	Bazar
1112	Sweaty Betty
1114	Salt
1116	Miansai
1118	Rag & Bone
1130	Kit and Ace
1132	Current/Elliott
1136	Suit Supply
1138	Strange Invisible Perfumes
1138 1/2	Le labo
1140	Cuyana
1142	Bluestar Donuts & Coffee
1144	Marine Layer
1146	Fala Bar

ARAGON COURT

1202	Kreation Cafe/Juicery
1204	Coutula
1208	Tortoise General Store
1212 A-C	Loft Space
1214	Media Monks
1216	The Perfect Piece
1222	Residential

CRADIZ COURT

1224	Aviator Nation
1302	Roosterfish
1306	World Wide Mind

1308 ABBOT KINNEY BOULEVARD

1310	Lucky Brand Jeans
1312	LF Store
1316	Tech Studio Mac & PC Repairs
1316 1/2	Huset
1326	Robert Graham

ANDALUSIA AVENUE

1338	Sleg
1340	Scotch & Soda
1342 1/2	Chariots on Fire
1344	TOMS
1346	Vacant
1348	Avocado
1350	Sofia Kaman Fine Jewels
1350	Lamia Thai Massage
1354	Ananda
1356	SkyLark
1358	Heavenly Couture
1360	Will Leather Goods

WESTMINSTER AVENUE

1101	YAS Yoga and Spinning
1103	Blue Bottle Coffee
1107	Junk Food Clothing
1107	Integrated Body Psychotherapy
1117	Brewster Parsons
1121	Industry of All Nations
1121	Negrin
1121	Kendall Conrad
1121	Three Square Cafe & Bakery

SAN JUAN AVENUE

1201	The Otherroom
1205	The Butcher's Daughter
1209	Bulldog Realtors
1219	Building
1219	AUST
1221	Keetsa Eco-Friendly Mattress
1223	Flannel
1225	Waraku USA
1227	Nightcap Clothing
1227	Burning Torch
1239	Greenleaf

SANTA CLARA AVENUE

1301	Wylie Wilson
1311	Private Building
1315	Angelo Electric, Inc
1317	Hamilton Press Gallery
1319	IRO
1319	B-Reel Office
1323	Principessa
1327	Velvet by Graham & Spencer
1327.5	John Fluevooy
1329	L. Angels
1329	Illesteva
1331	Kilogram Tea
1335	Available
1335.5	Guild
1337	Alternative Apparel
1341	Beauville Glass Designs
1345	Remodeling
1349	In Leases
1351	Hourglass Cosmetics
1353-	Vince
1357	Salt & Straw

CALIFORNIA AVENUE



**Newmark Grubb
Knight Frank**

JAY LUCHS
EXECUTIVE VICE PRESIDENT
Lic #01260345
T: 310.407.6585
Jay.Luchs@ngkf.com



STEVEN GELBER
Lic #00872302
T: 310.824.4999 x15
Steven.Gelber@gmail.com

WWW.JAYLUCHS.COM
WWW.ABBOTKINNEYRETAIL.COM