

1310 ABBOT KINNEY BLVD

VENICE, CA



PREMIERE 50 YARD LINE LOCATION

EXCELLENT RETAIL OPPORTUNITY
ON ABBOT KINNEY

SIZE
1,350 SF

RENT
\$16 PSF PER MONTH NNN



JAY LUCHS
EXECUTIVE VICE PRESIDENT
Lic #01260345
T: 310.407.6585
Jay.Luchs@ngkf.com



STEVEN GELBER
Lic #00872302
T: 310.824.4999 x15
Steven.Gelber@gmail.com

WWW.JAYLUCHS.COM
WWW.ABBOTKINNEYRETAIL.COM

1310 ABBOT KINNEY BLVD

VENICE, CA

ABBOT KINNEY BLVD.

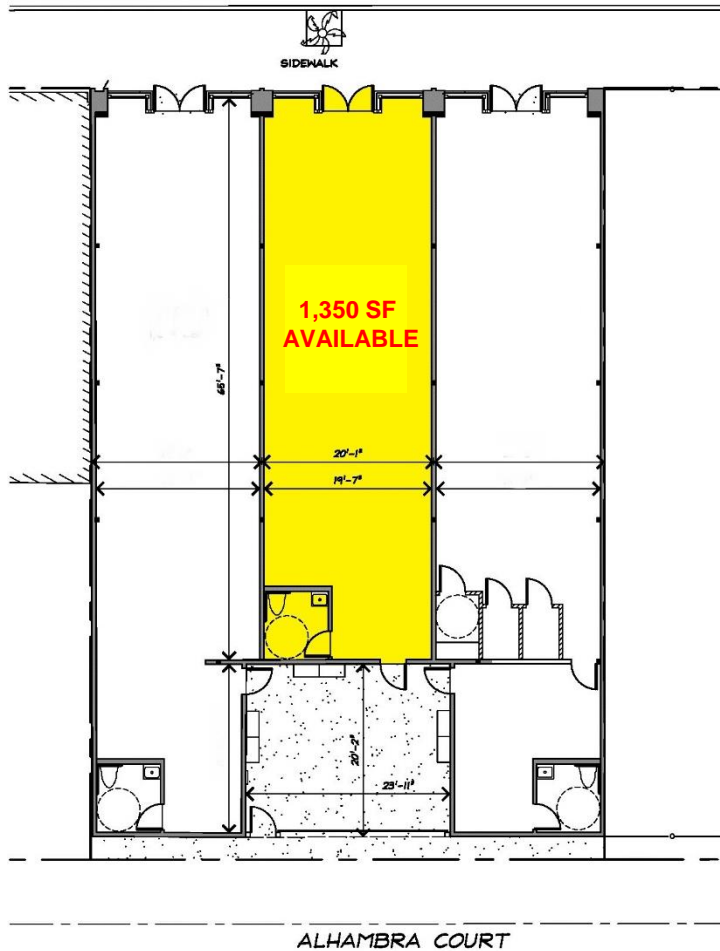

JAY LUCHS
EXECUTIVE VICE PRESIDENT
Lic #01260345
T: 310.407.6585
Jay.Luchs@ngkf.com



STEVEN GELBER
Lic #00872302
T: 310.824.4999 x15
Steven.Gelber@gmail.com

WWW.JAYLUCHS.COM

WWW.ABBOTKINNEYRETAIL.COM

1310 ABBOT KINNEY BLVD

VENICE, CA

WESTMINSTER AVENUE

Heist	1100
C.A.V.E Gallery Bazar	1108 1108C
Sweaty Betty	1112
Salt	1114
Miansai	1116
Rag & Bone	1118
Kit and Ace	1130
Current/Elliott	1132
Suit Supply	1136
Strange Invisible Perfumes	1138
Le labo	1138 1/2
Cuyana	1140
Bluestar Donuts & Coffee	1142
Marine Layer	1144
Fala Bar	1146

ARAGON COURT

Kreation Kafe/Juicery	1202
Coutilla	1204
Tortoise General Store	1208
Loft Space	1212 A-C
Media Monks	1214
The Perfect Piece	1216
Residential	1222
Aviator Nation	1224

GRADIZ COURT

Roosterfish	1302
World Wide Mind	1306
future Pixi Beauty	1308

1310 ABBOT KINNEY BLVD

LF Store	1312
Tech Studio Mac & PC Repairs	1316
Huset	1316 1/2
Robert Graham	1326

ANDAULSIA AVENUE

Stag	1338
Scotch & Soda	1340
Chartots on Fire	1342 1/2
TOMS	1344
Vacant	1346
Avocado	1348
Soffia Kaman Fine Jewels	1350
Lamia Thai Massage	1350
Ananda	1354
Sky/lark	1356
Heavenly Couture	1358
Will Leather Goods	1360

WESTMINSTER AVENUE

YAS Yoga and Spinning	1101
Blue Bottle Coffee	1103
Junk Food Clothing	1107
Integrated Body Psychotherapy	1107
Brewster Parsons	1117
Industry of All Nations	1121
Negarlin	1121
Kendall Conrad	1121
Three Square Café & Bakery	1121

SAN JUAN AVENUE

The Otherroom	1201
The Butcher's Daughter	1205
Buildog Realtors	1209
Building	1219
AUST	1219
Keetsa Eco-Friendly Mattress	1221
Flannel	1223
Waraku USA	1225
Nightcap Clothing	1227
Burning Torch	1227
Greenleaf	1239

SANTA CLARA AVENUE

Wylie Wilson	1301
Private Building	1311
Angelo Electric, Inc	1315
Hamilton Press Gallery	1317
IRO	1319
B-Reel Office	1319
Principessa	1323
Velvet by Graham & Spencer	1327
John Fluevov	1327.5
L. Angels	1329
Illesteva	1329
Kilogram Tea	1331
Available	1335
Guild	1335.5
Alternative Apparel	1337
Beauville Glass Designs	1341
Remodeling	1345
In Leases	1349
Hourglass Cosmetics	1351
Vince	1353-
1355	1355
Salt & Straw	1357

CALIFORNIA AVENUE



**Newmark Grubb
Knight Frank**

JAY LUCHS
EXECUTIVE VICE PRESIDENT
Lic #01260345
T: 310.407.6585
Jay.Luchs@ngkf.com



STEVEN GELBER
Lic #00872302
T: 310.824.4999 x15
Steven.Gelber@gmail.com

WWW.JAYLUCHS.COM

WWW.ABBOTKINNEYRETAIL.COM