

The Retail at Watt Plaza

1875 CENTURY PARK EAST

LOS ANGELES, CALIFORNIA 90067



JAY LUCHS
CARLY GELLER
NEWMARK

Vice Chairman 310-407-6585
Director - Jay Luchs Group 310-593-0760
JAYLUCHS.COM

jay.luchs@nrmk.com
carly.geller@nrmk.com

CA RE Lic. #01260345
CA RE Lic. #02153582

jayluchs.com
For Lease
310 407 6585
Jay Luchs
Los Angeles

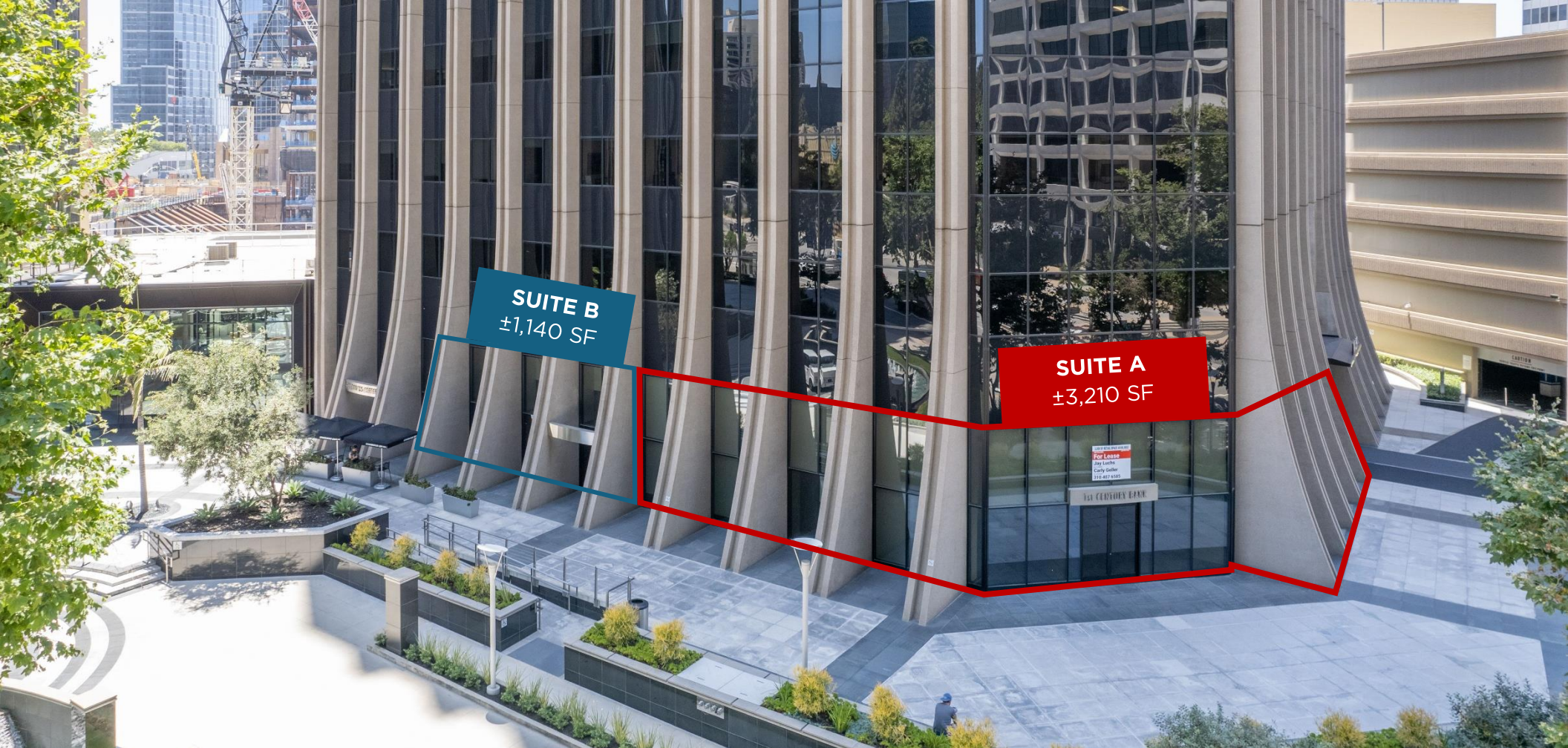

ADDRESS

1875 Century Park East
Los Angeles, CA 90067

USE

Restaurant or Retail

SIZE

Suite A: ±3,210 SF
Suite B: ±1,140 SF

AVAILABLE

Immediately

RENT

Available Upon Request

PARKING

Valet and self-park available

HIGHLIGHTS

- Retail at the base of a 23-story, 900,000 SF office building in the heart of Century City
- Retail covenants in the building include Starbucks, Carla Café, Fed Ex, Allegiate Gym, Mickey Fine Pharmacy and Snack and Dry Cleaners
- Outdoor seating available

JAY LUCHS
CARLY GELLER
NEWMARK

Vice Chairman 310-407-6585
Director – Jay Luchs Group 310-593-0760
JAYLUCHS.COM

jay.luchs@nrmk.com
carly.geller@nrmk.com

CA RE Lic. #01260345
CA RE Lic. #02153582

jayluchs.com
For Lease
310 407 6585
Jay Luchs
Los Angeles

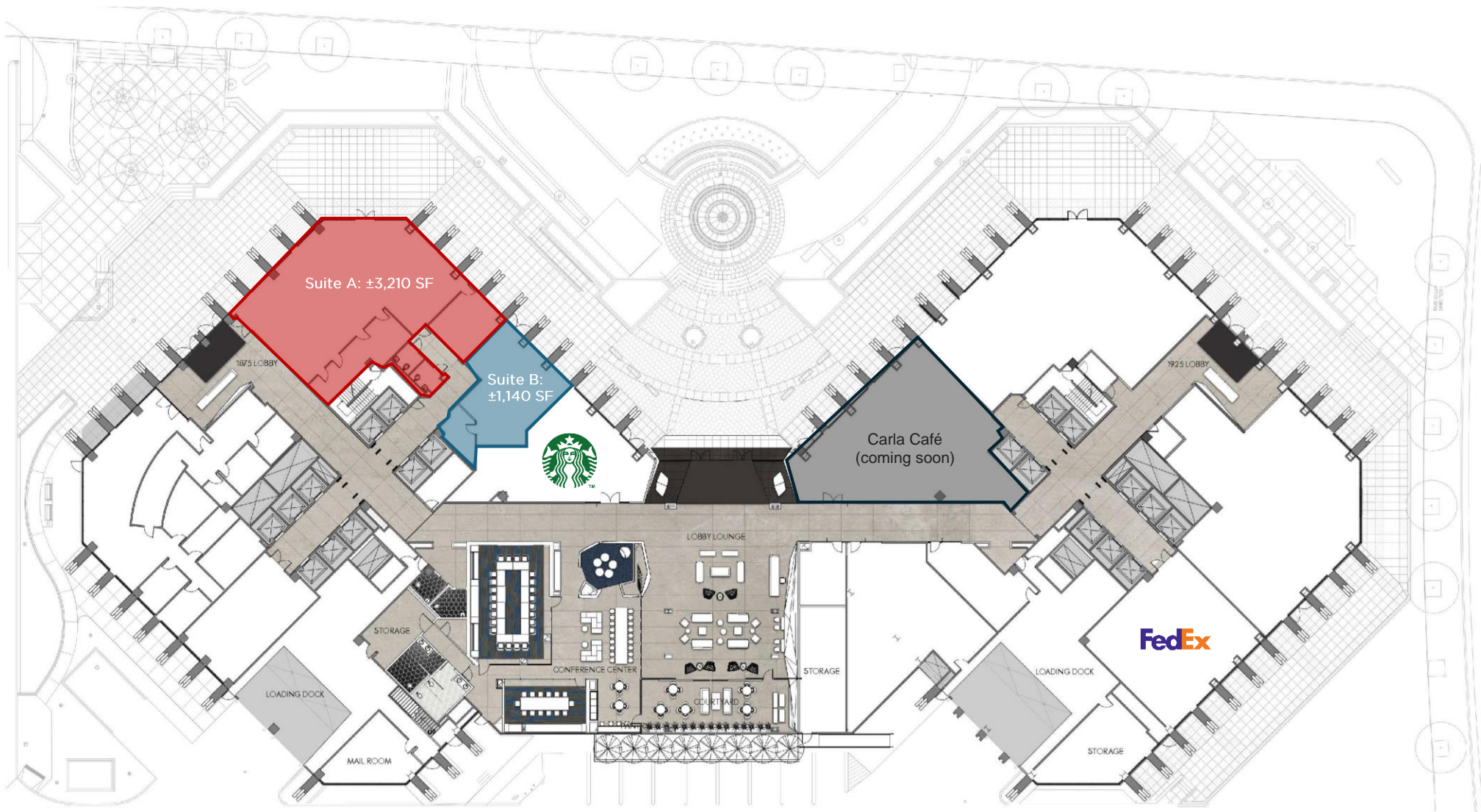

JAY LUCHS
CARLY GELLER
NEWMARK

Vice Chairman 310-407-6585
 Director – Jay Luchs Group 310-593-0760
JAYLUCHS.COM

jay.luchs@nrmk.com
 carly.geller@nrmk.com

CA RE Lic. #01260345
 CA RE Lic. #02153582

jayluchs.com
For Lease
310 407 6585
Jay Luchs
Los Angeles



The information contained herein has been obtained from sources deemed reliable but has not been verified and no guarantee, warranty or representation, either express or implied, is made with respect to such information. Terms of sale or lease and availability are subject to change or withdrawal without notice.

Corporate RE Lic #01355491

JAY LUCHS
CARLY GELLER
NEWMARK

Vice Chairman 310-407-6585
Director - Jay Luchs Group 310-593-0760
JAYLUCHS.COM

jay.luchs@nrmk.com
carly.geller@nrmk.com

CA RE Lic. #01260345
CA RE Lic. #02153582

jayluchs.com
For Lease
310 407 6585
Jay Luchs
Los Angeles