

8 5 7 6 - 8 5 9 4
SANTA MONICA
BOULEVARD
WEST HOLLYWOOD, CA 90069



JAY LUCHS
CARLY GELLER
NEWMARK
PACIFIC

Executive Vice Chairman
Director-Jay Luchs Group
JAYLUCHS.COM

310-407-6585
310-593-0760

jay.luchs@nmrk.com
carly.geller@nmrk.com

CA RE Lic. #01260345
CA RE Lic. #02153582

jayluchs.com
For Lease
310 407 6585
Jay Luchs
Los Angeles

AVAILABLE SPACE



JAY LUCHS
CARLY GELLER
NEWMARK
PACIFIC

Executive Vice Chairman
Director-Jay Luchs Group
JAYLUCHS.COM

310-407-6585
310-593-0760

jay.luchs@nmrk.com
carly.geller@nmrk.com

CA RE Lic. #01260345
CA RE Lic. #02153582

jayluchs.com
For Lease
310 407 6585
Jay Luchs
Los Angeles



ADDRESS

8576 Santa Monica Boulevard
West Hollywood, CA 90069

USE

Retail

SIZE

±1,468 SF

RENT

Available upon Request

AVAILABLE

Negotiable



JAY LUCHS
CARLY GELLER
NEWMARK
PACIFIC

Executive Vice Chairman
Director-Jay Luchs Group
JAYLUCHS.COM

310-407-6585
310-593-0760

jay.luchs@nmrk.com
carly.geller@nmrk.com

CA RE Lic. #01260345
CA RE Lic. #02153582

jayluchs.com
For Lease
310 407 6585
Jay Luchs
Los Angeles

8576 SANTA MONICA BOULEVARD FLOOR PLAN

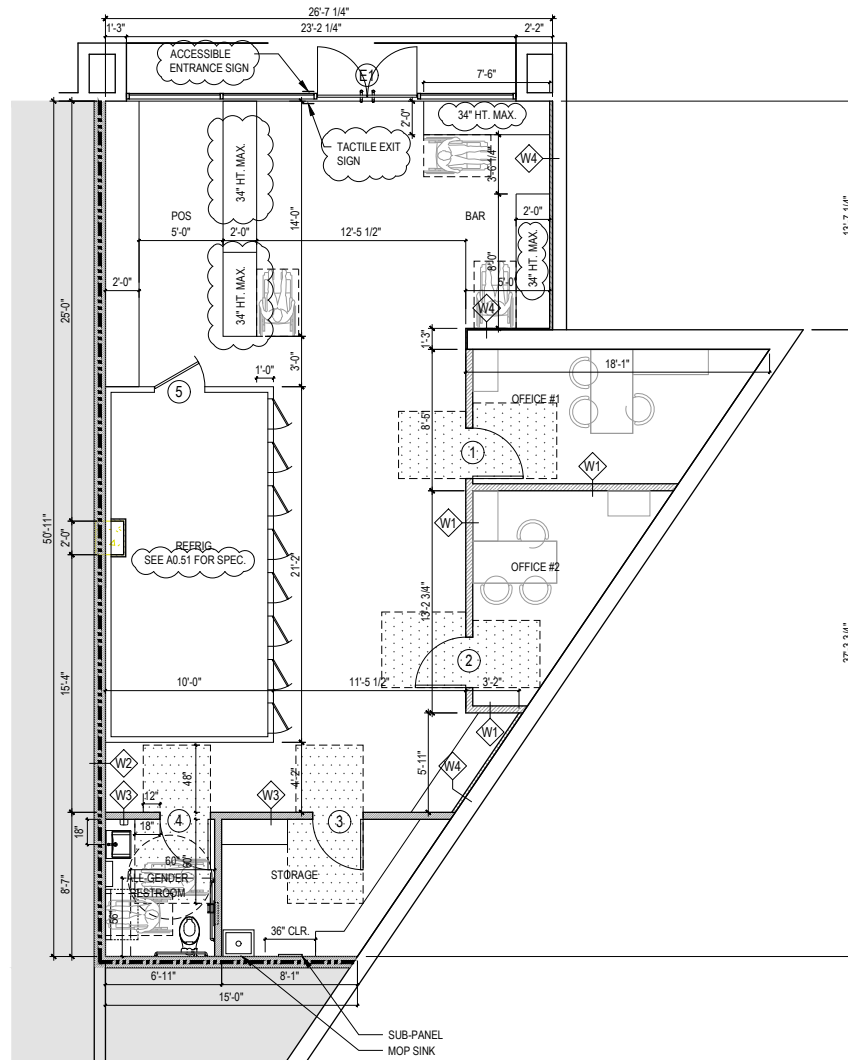

JAY LUCHS
CARLY GELLER
NEWMARK
 PACIFIC

Executive Vice Chairman
 Director-Jay Luchs Group
JAYLUCHS.COM

310-407-6585
 310-593-0760

jay.luchs@nrmk.com
 carly.geller@nrmk.com

CA RE Lic. #01260345
 CA RE Lic. #02153582

For Lease
 310 407 6585
Jay Luchs
 Los Angeles



ADDRESS

8594 Santa Monica Boulevard
West Hollywood, CA 90069

USE

Retail/Restaurant

SIZE

±867 SF

RENT

Available upon Request

AVAILABLE

Immediately

JAY LUCHS
CARLY GELLER
NEWMARK
PACIFIC

Executive Vice Chairman
Director-Jay Luchs Group
JAYLUCHS.COM

310-407-6585
310-593-0760

jay.luchs@nmrk.com
carly.geller@nmrk.com

CA RE Lic. #01260345
CA RE Lic. #02153582

jayluchs.com
For Lease
310 407 6585
Jay Luchs
Los Angeles



HIGHLIGHTS

- Centrally located in West Hollywood
- On-site parking in multi-level garage
- Frontage on Santa Monica Boulevard
- Signage opportunity
- Expansive frontage and visibility on Santa Monica Boulevard

NEIGHBORING TENANTS



JAY LUCHS
CARLY GELLER
NEWMARK
 PACIFIC

Executive Vice Chairman
 Director-Jay Luchs Group
JAYLUCHS.COM

310-407-6585
 310-593-0760

jay.luchs@nmrk.com
 carly.geller@nmrk.com

CA RE Lic. #01260345
 CA RE Lic. #02153582

jayluchs.com
For Lease
310 407 6585
Jay Luchs
 Los Angeles



JAY LUCHS
CARLY GELLER
NEWMARK
 PACIFIC

Executive Vice Chairman
 Director-Jay Luchs Group
JAYLUCHS.COM

310-407-6585
 310-593-0760

jay.luchs@nmrk.com
 carly.geller@nmrk.com

CA RE Lic. #01260345
 CA RE Lic. #02153582

For Lease
310 407 6585
Jay Luchs
 Los Angeles



Traffic Count: Costar, TrafficMetrix2022

The information contained herein has been obtained from sources deemed reliable but has not been verified and no guarantee, warranty or representation, either express or implied, is made with respect to such information. Terms of sale or lease and availability are subject to change or withdrawal without notice.

Corporate RE License #01796698

JAY LUCHS
CARLY GELLER
NEWMARK
 PACIFIC

Executive Vice Chairman
 Director-Jay Luchs Group
JAYLUCHS.COM

310-407-6585
 310-593-0760

jay.luchs@nmrk.com
 carly.geller@nmrk.com

CA RE Lic. #01260345
 CA RE Lic. #02153582

For Lease
 310 407 6585
Jay Luchs
 Los Angeles