

# 8811 SANTA MONICA BOULEVARD

WEST HOLLYWOOD, CA 90069



**JAY LUCHS**  
**CARLY GELLER**  
**NEWMARK**

Vice Chairman  
Associate Director  
**JAYLUCHS.COM**

310-407-6585  
310-593-0760

[jay.luchs@nrmk.com](mailto:jay.luchs@nrmk.com)  
[carly.geller@nrmk.com](mailto:carly.geller@nrmk.com)

CA RE Lic. #01260345  
CA RE Lic. #02153582

jayluchs.com  
**For Lease**  
**310 407 6585**  
**Jay Luchs**  
Los Angeles



## ADDRESS

8811 Santa Monica Boulevard  
West Hollywood, CA 90069

## USE

Restaurant/Retail

## SIZE

±3,500 SF plus patio

## RENT

\$24,000 per month NNN

## FRONTAGE

±58' on Santa Monica Boulevard  
±96' on Larrabee Street

## SUBLEASE TERM

Through October 31, 2031

**JAY LUCHS**  
**CARLY GELLER**  
**NEWMARK**

Vice Chairman  
Associate Director  
**JAYLUCHS.COM**

310-407-6585  
310-593-0760

jay.luchs@nrmk.com  
carly.geller@nrmk.com

CA RE Lic. #01260345  
CA RE Lic. #02153582

jayluchs.com  
**For Lease**  
**310 407 6585**  
**Jay Luchs**  
Los Angeles



## HIGHLIGHTS

- » Located on the corner of Santa Monica Boulevard and Larrabee Street
- » Formerly Flaming Saddles
- » Upstairs will be a future cannabis lounge (approximately 130 seats), allowing for a partnership opportunity to serve the clientele
- » Permitted to serve: Liquor CUP until 2 AM, Food until 4 AM
- » Patio space available along Santa Monica Boulevard



**JAY LUCHS**  
**CARLY GELLER**  
**NEWMARK**

Vice Chairman  
 Associate Director  
**JAYLUCHS.COM**

310-407-6585  
 310-593-0760

jay.luchs@nrmk.com  
 carly.geller@nrmk.com

CA RE Lic. #01260345  
 CA RE Lic. #02153582

jayluchs.com  
**For Lease**  
**310 407 6585**  
**Jay Luchs**  
 Los Angeles

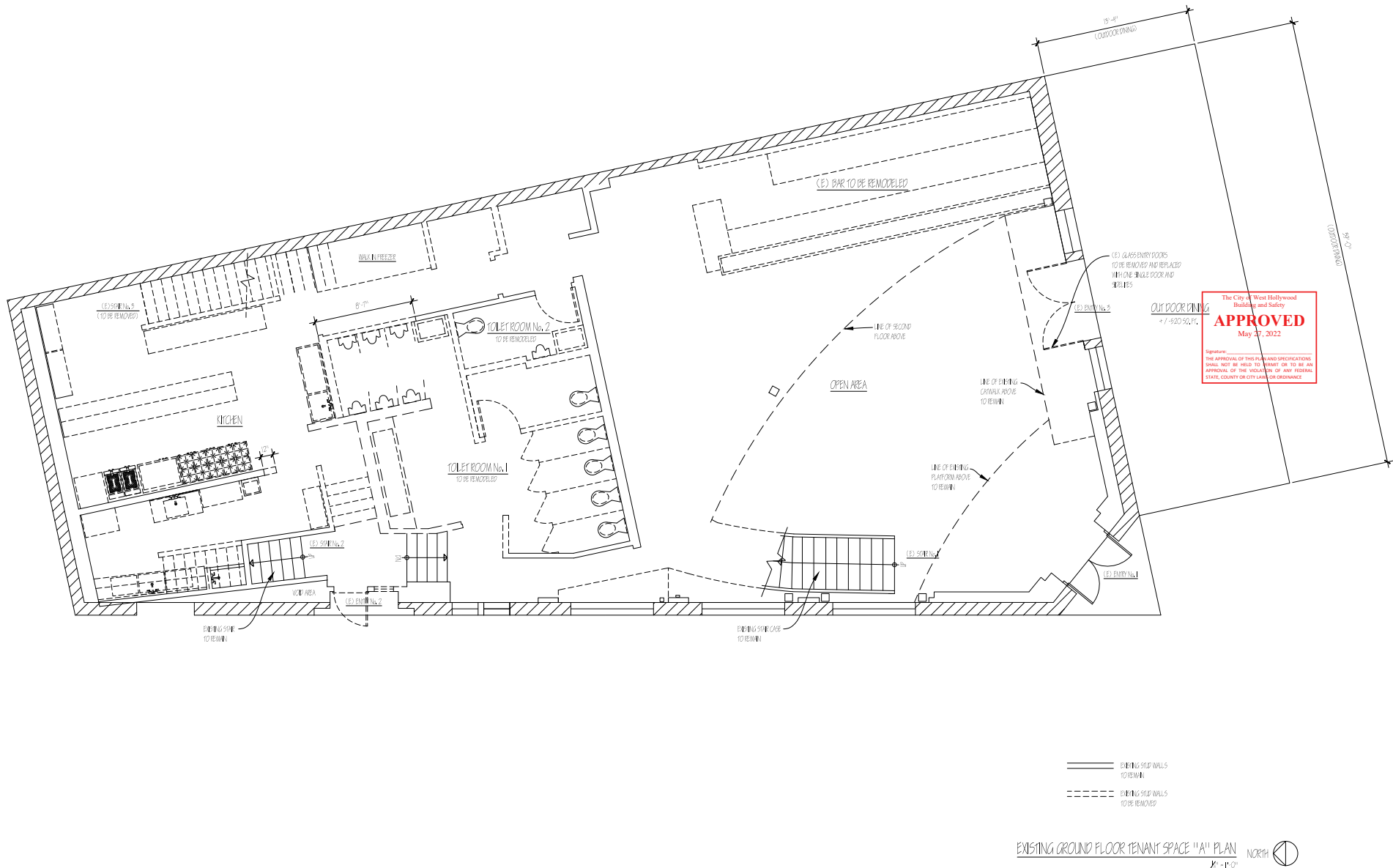



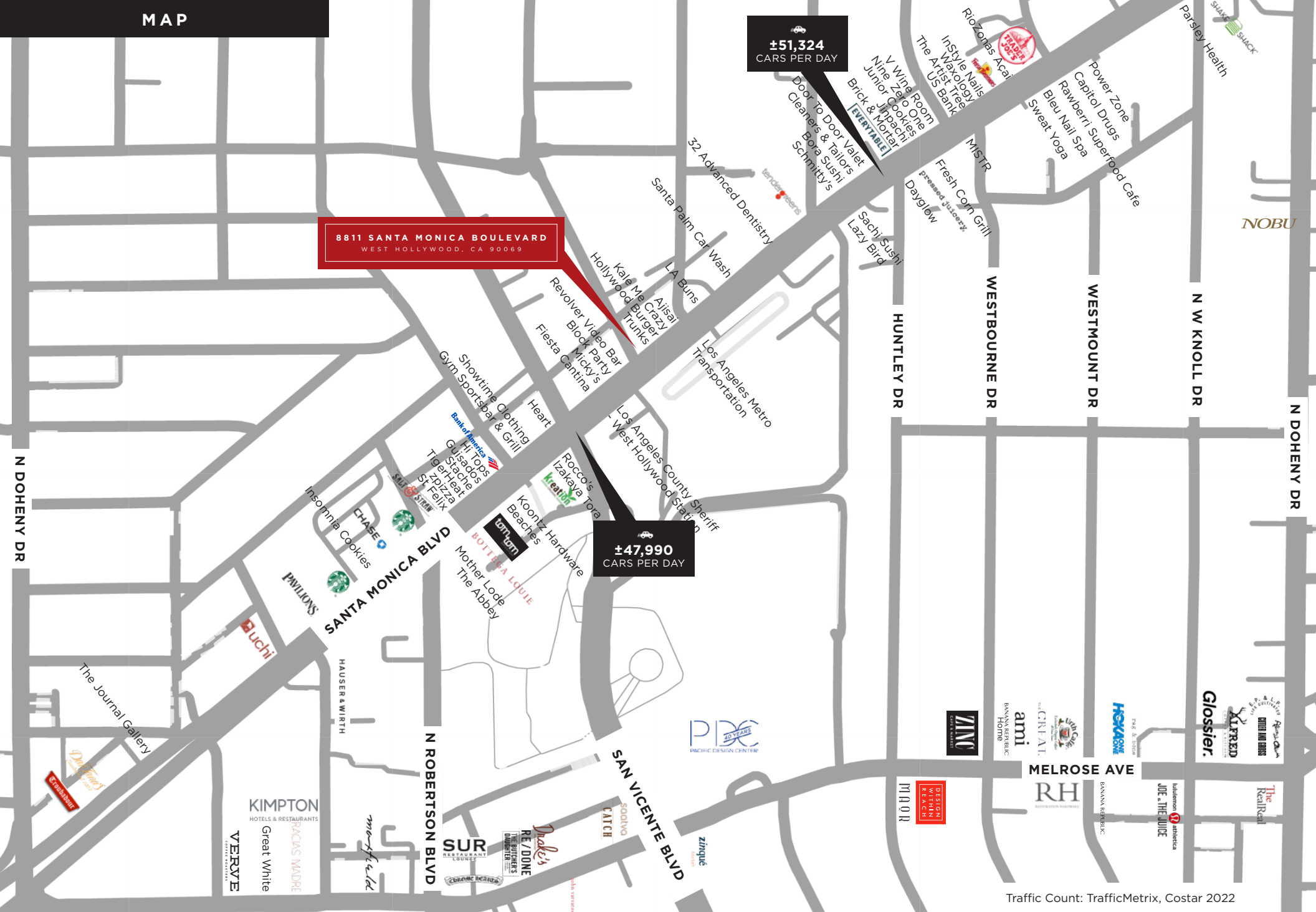

**8811 SANTA MONICA BOULEVARD**  
WEST HOLLYWOOD, CA 90069

**±51,324**  
CARS PER DAY

**±47,990**  
CARS PER DAY

Traffic Count: TrafficMetrix, Costar 2022

**JAY LUCHS**  
**CARLY GELLER**  
**NEWMARK**

Vice Chairman  
Associate Director  
**JAYLUCHS.COM**

310-407-6585  
310-593-0760

[jay.luchs@nrmk.com](mailto:jay.luchs@nrmk.com)  
[carly.geller@nrmk.com](mailto:carly.geller@nrmk.com)

CA RE Lic. #01260345  
CA RE Lic. #02153582

[jayluchs.com](http://jayluchs.com)  
**For Lease**  
**310 407 6585**  
**Jay Luchs**  
Los Angeles

±2 MIN  
±0.4 Miles from  
Sunset Strip

±51,324  
CARS PER DAY

8811 SANTA MONICA BOULEVARD  
WEST HOLLYWOOD, CA 90069



1  
HOTELS

MONDRIAN

TRADER  
JOE'S

FRESH  
PRODUCE

JUNIOR COOKIES

Jinpachi

EVERYTABLE

Bora Sushi

Schmitt's

SHAKE  
SHACK

Fresh Corn Grill

pressed juicery

Sachi Sushi

Lazy Bird

LA Buns

Kale Me Crazy

Hollywood Burger

Trunks

mistr  
I HO, YOU HO, WEHO  
...together on PREP

Revolver Video Bar

Block Party WeHo

Micky's

SANTA MONICA BOULEVARD

Los Angeles County  
Sheriff - West  
Hollywood Station

Traffic Count: TrafficMetrix, Costar 2022

JAY LUCHS  
CARLY GELLER  
NEWMARK

Vice Chairman  
Associate Director  
JAYLUCHS.COM

310-407-6585  
310-593-0760

jay.luchs@nrmk.com  
carly.geller@nrmk.com

CA RE Lic. #01260345  
CA RE Lic. #02153582

jayluchs.com  
For Lease  
310 407 6585  
Jay Luchs  
Los Angeles



Los Angeles County Sheriff - West Hollywood Station

±47,990 CARS PER DAY

SANTA MONICA BOULEVARD

8811 SANTA MONICA BOULEVARD  
WEST HOLLYWOOD, CA 90069

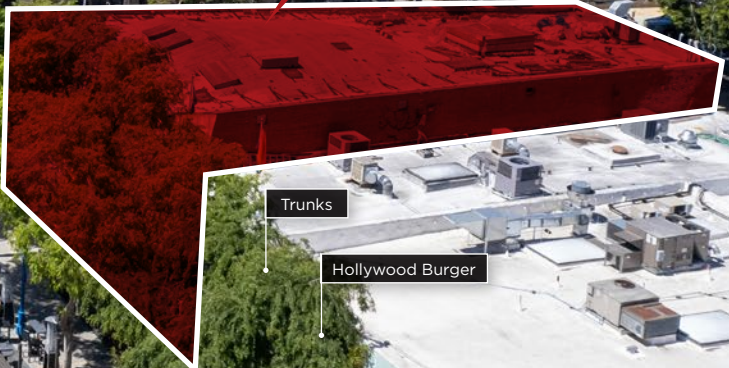

Trunks

Hollywood Burger

Kale Me Crazy

Traffic Count: TrafficMetrix, Costar 2022

JAY LUCHS  
CARLY GELLER  
NEWMARK

Vice Chairman  
Associate Director  
JAYLUCHS.COM

310-407-6585  
310-593-0760

jay.luchs@nrmk.com  
carly.geller@nrmk.com

CA RE Lic. #01260345  
CA RE Lic. #02153582

jayluchs.com  
For Lease  
310 407 6585  
Jay Luchs  
Los Angeles



# 8811 SANTA MONICA BOULEVARD

WEST HOLLYWOOD, CA 90069



The information contained herein has been obtained from sources deemed reliable but has not been verified and no guarantee, warranty or representation, either express or implied, is made with respect to such information. Terms of sale or lease and availability are subject to change or withdrawal without notice.

**JAY LUCHS**  
**CARLY GELLER**  
**NEWMARK**

Vice Chairman  
Associate Director  
**JAYLUCHS.COM**

310-407-6585  
310-593-0760

*Corporate RE Lic. #01355491*

[jay.luchs@nrmk.com](mailto:jay.luchs@nrmk.com)  
[carly.geller@nrmk.com](mailto:carly.geller@nrmk.com)

CA RE Lic. #01260345  
CA RE Lic. #02153582

jayluchs.com  
**For Lease**  
**310 407 6585**  
**Jay Luchs**  
Los Angeles