

9001 SANTA MONICA BLVD

RETAIL | RESTAURANT OPPORTUNITY



JAY LUCHS

Vice Chairman

310-407-6585

jay.luchs@nrmk.com

CA RE Lic. #01260345

JAYLUCHS.COM

CARLY GELLER

Associate Director

310-593-0760

carly.geller@nrmk.com

CA RE Lic. #02153582

NEWMARK

9001 SANTA MONICA BLVD

5 story mixed-use building with luxury apartments designed by Steinberg Hart



JAY LUCHS

Vice Chairman

310-407-6585

jay.luchs@nmrk.com

CA RE Lic. #01260345

JAYLUCHS.COM

CARLY GELLER

Associate Director

310-593-0760

carly.geller@nmrk.com

CA RE Lic. #02153582

NEWMARK



ADDRESS

9001 Santa Monica Blvd
Located just west of the
intersection of Santa Monica and
Robertson Boulevards

SIZE

Retail #1: ±1,000 SF (plus ±193 SF
Patio Area)

PARKING

65 dedicated retail spaces

RENT

Available upon Request

JAY LUCHS

Vice Chairman

310-407-6585

jay.luchs@nrmk.com

CA RE Lic. #01260345

JAYLUCHS.COM

CARLY GELLER

Associate Director

310-593-0760

carly.geller@nrmk.com

CA RE Lic. #02153582

NEWMARK

9001 SANTA MONICA BLVD

FLOOR PLAN

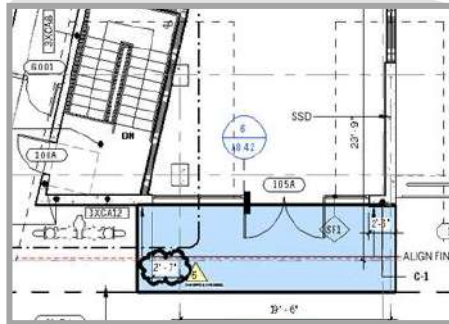
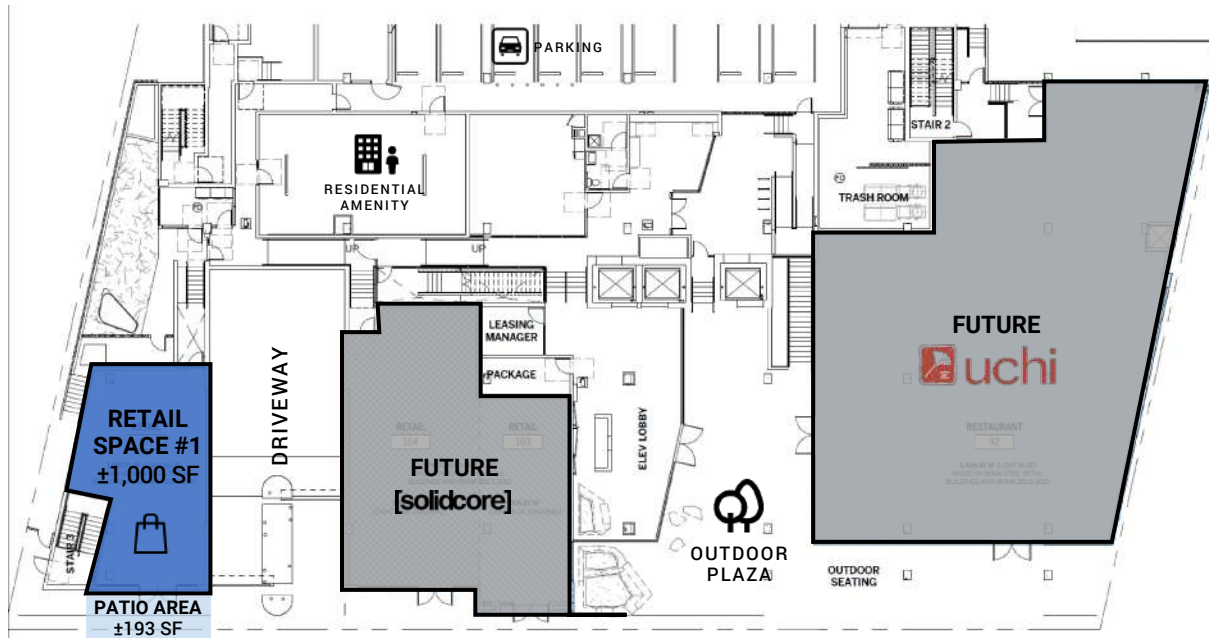

JAY LUCHS

Vice Chairman

310-407-6585

jay.luchs@nrmk.com

CA RE Lic. #01260345

JAYLUCHS.COM

CARLY GELLER

Associate Director

310-593-0760

carly.geller@nrmk.com

CA RE Lic. #02153582

NEWMARK

9001 SANTA MONICA BLVD

RETAIL | RESTAURANT OPPORTUNITY

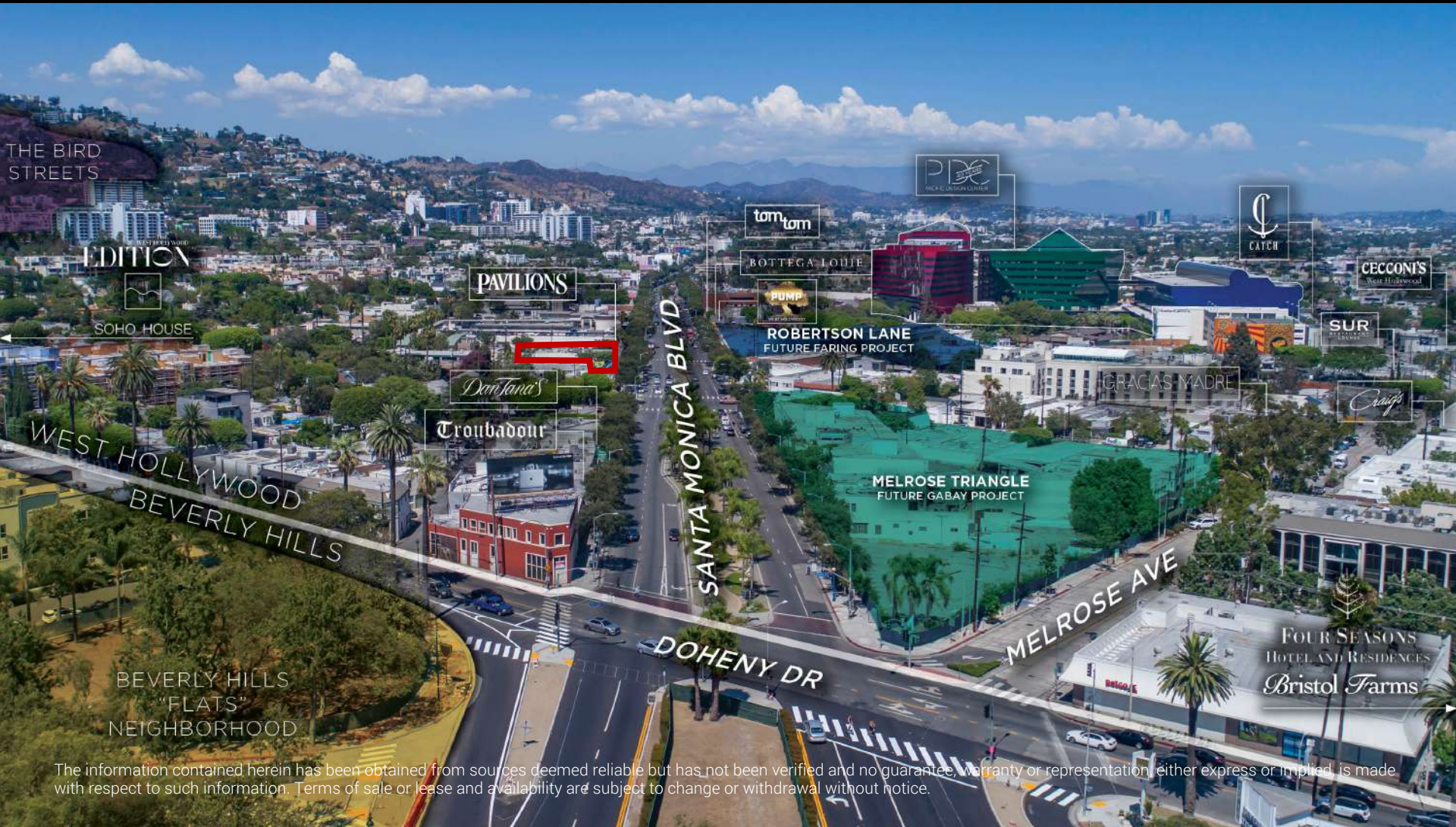

The information contained herein has been obtained from sources deemed reliable but has not been verified and no guarantee, warranty or representation, either express or implied, is made with respect to such information. Terms of sale or lease and availability are subject to change or withdrawal without notice.

JAY LUCHS

Vice Chairman

310-407-6585

jay.luchs@nrmk.com

CA RE Lic. #01260345

JAYLUCHS.COM

CARLY GELLER

Associate Director

310-593-0760

carly.geller@nrmk.com

CA RE Lic. #02153582

NEWMARK